

Approx Gross Internal Area
57 sq m / 610 sq ft

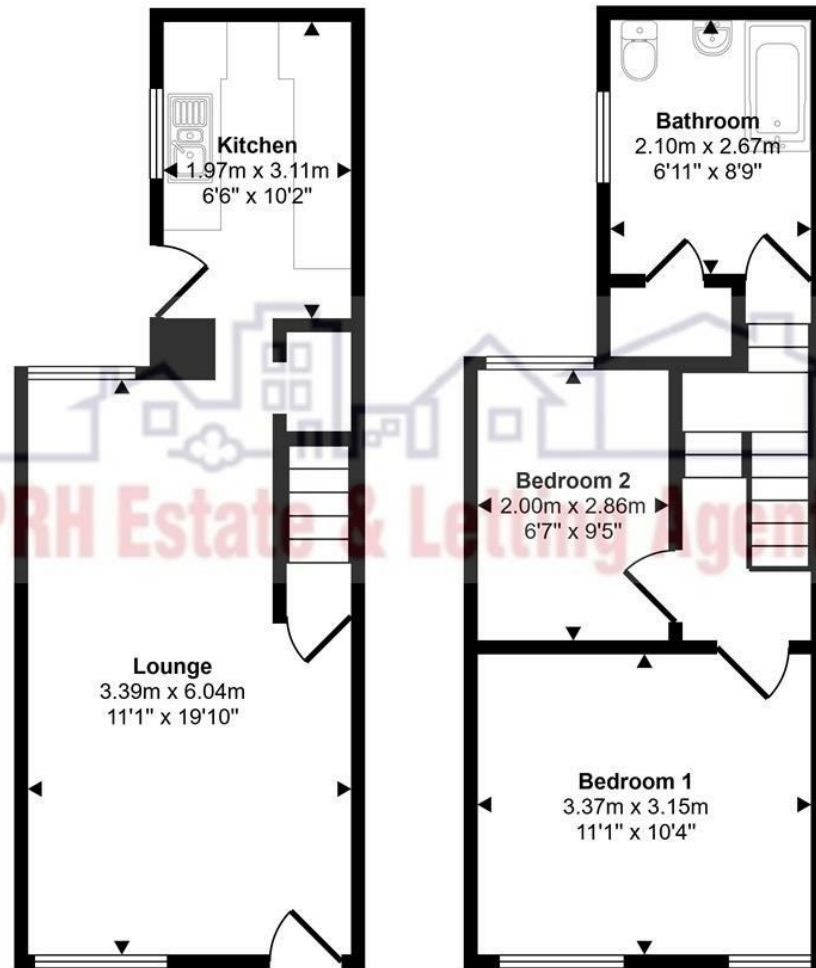

Ground Floor
Approx 28 sq m / 300 sq ft

First Floor
Approx 29 sq m / 310 sq ft



Penzance

£850



1 Wood Street
Penzance
TR18 2EW

£850

KEY FEATURES

- Long Term Let
- Available Immediately
- Mains Gas, Electric, Water & Drainage
- Gas Central Heating
- Double Glazed
- EPC D (59 88)
- 2 Bedrooms
- £850 Rent
- £850 Deposit
- No Internet connection - Ofcom suggest Ultrafast is available and that mobile coverage is average on most networks

DIRECTIONS

From the bottom of Causewayhead, turn left onto Bread Street. Continue along Bread Street until you reach The Crown Inn. Wood Street is located immediately on your right, and the property can be found shortly after, also on the right-hand side, clearly identified by our PRH 'To Let' board.



2 Bedroom House – Market Jew Street,
Penzance – £850 pcm

The Property

Situated in a prime central location just off Market Jew Street, this two-bedroom end-of-terrace home offers convenient town living with the benefit of being tucked away from the main thoroughfare.

The ground floor features a welcoming lounge with stairs leading to the first floor and direct access to a functional kitchen. Upstairs, you will find two bedrooms and a family bathroom. To the rear of the property is a low-maintenance paved courtyard.

Location

You couldn't be better placed for local amenities. Within a short stroll, you have the main shopping precinct, local cafes, and the Penzance Railway & Bus Station, providing direct links to Truro, Plymouth, and London Paddington.

Key Details:

Rent: £850 per calendar month

Deposit: £850 (Protected with the TDS)

Availability: Immediately / Long Term

Council Tax: Band B (Cornwall Council)

EPC Rating: D (59) with a potential of B (88)

Services: All mains services connected.

Connectivity: Ultrafast Broadband available in the area but none connected and good mobile coverage (Source: Ofcom).

Viewing is highly recommended for those seeking a long-term home in the heart of Penzance.

